



# SWINGSET™ DISTRIBUTORS



Bulletin SWD-15

## **SWINGSET DISTRIBUTORS**

The unique pendulum type movement of the SwingSet Distributor inner spout offers advantages not found in other types of distributors. The material going through the distributor impacts a different spot in the flex's and inner spout as the spout is moved from one outlet to another. Thus, an inner spout of a certain gauge construction will outlast a similar type spout in a rotating style distributor. The in-line arrangement of outlet ducts makes it more suitable in some bin configurations than a rotating type distributor. It is frequently the best choice for applications when two or more legs must feed the distributor but a minimum number of outlets are required.

SwingSet Distributors are manufactured with single, double, triple and quadruple spouts. Standard options include replaceable lining in the inner spouts and ducts, electric operators and special flanging.

All controls are accessible from the outside. This provides a weather and dust tight enclosure and simplifies installation. On manually operated single or double spout units, the control wheels are located all on one side to minimize the use of pulleys and maintain the excellent "feel" of the spout position.

The non-adjustable spout locking mechanism in manual distributors positively engages in the duct, insuring error free positioning and eliminates mixing between adjacent ducts.

Round flanged inlets and ducts (outlets) conform to standard spouting methods, ruling out the need for special transitions.

Both ends open fully to afford easy access to the inside for inspection and maintenance. All internal working parts and liners can be removed and installed without disassembling external spouting.

## **45° DISTRIBUTORS**

This is the standard distributor supplied. It is used with whole grains, fertilizer and free flowing feed products.

## **55° DISTRIBUTORS**

The 55 degree distributor is used whenever you have a sluggish product such as mixed feed with fat or molasses in it. These units average about 30% taller than a 45 degree unit.

If you are handling both free flowing and sluggish materials, you may be able to use a 45 degree distributor by only running the sluggish material through the ducts closest to the center and the free flowing products through the outer ducts.

## **FERTILIZER DISTRIBUTORS**

The construction of a fertilizer distributor is the same as an all mild steel distributor except for the following additions:

1. All parts that move against one another, to affect the swinging of the inner spout, are made of type 304 stainless steel. This consists of the inner spout, spout flexes, spout latch plate, hanger, shields and pivot rods for flexes.
2. The interior roller chain is stainless steel.
3. Stainless steel operating cable is provided for 50 feet of operation.
4. As an option, complete sandblasting and epoxy coating of the exterior and interior of the unit is available.

## FEATURES & OPTIONS

### STAINLESS STEEL OR GALVANIZED STEEL DISTRIBUTORS

Any style distributor can be ordered using either stainless steel (type 304 standard) or galvanized steel construction.

### ELECTRICALLY OPERATED

Electronic "EDI" Control and limit switch control are available for SwingSet distributors. For better detailed information see the EDI Distributor Control brochure.

### OVERSIZE OUTLET DUCTS

Oversize discharge ducts are available to allow you to feed into a specific duct with more than one inner spout simultaneously. An example would be an 8 inch double distributor with one duct having a 12 inch diameter opening rather than the normal 8 inch diameter.

### SPECIAL INLET AND OUTLET CONFIGURATIONS

Inlets and outlets are available in styles other than the standard round spout. Outlets can be square or rectangular to match square spouting. Inlets can not be square but are available with a rectangular opening equal in square inch opening to the round spout size. Consult factory for details.

### POSITIVE PRESSURE FAN

The optional fan can be used to create positive air pressure in the distributor to help prevent the build up of moisture and dust from the bin. Positive pressure fans are available for manual or electric distributors.

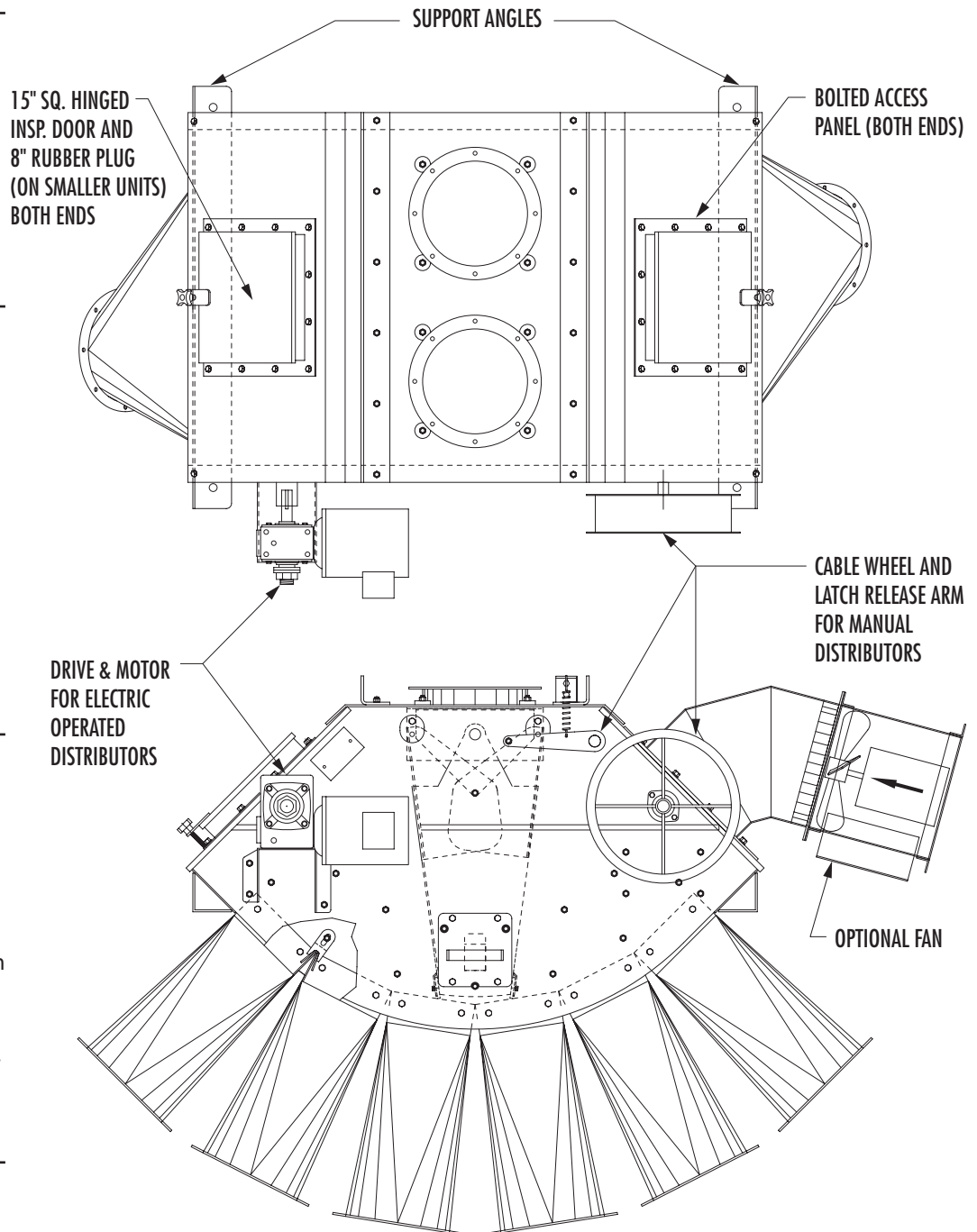

STANDARD DUTY

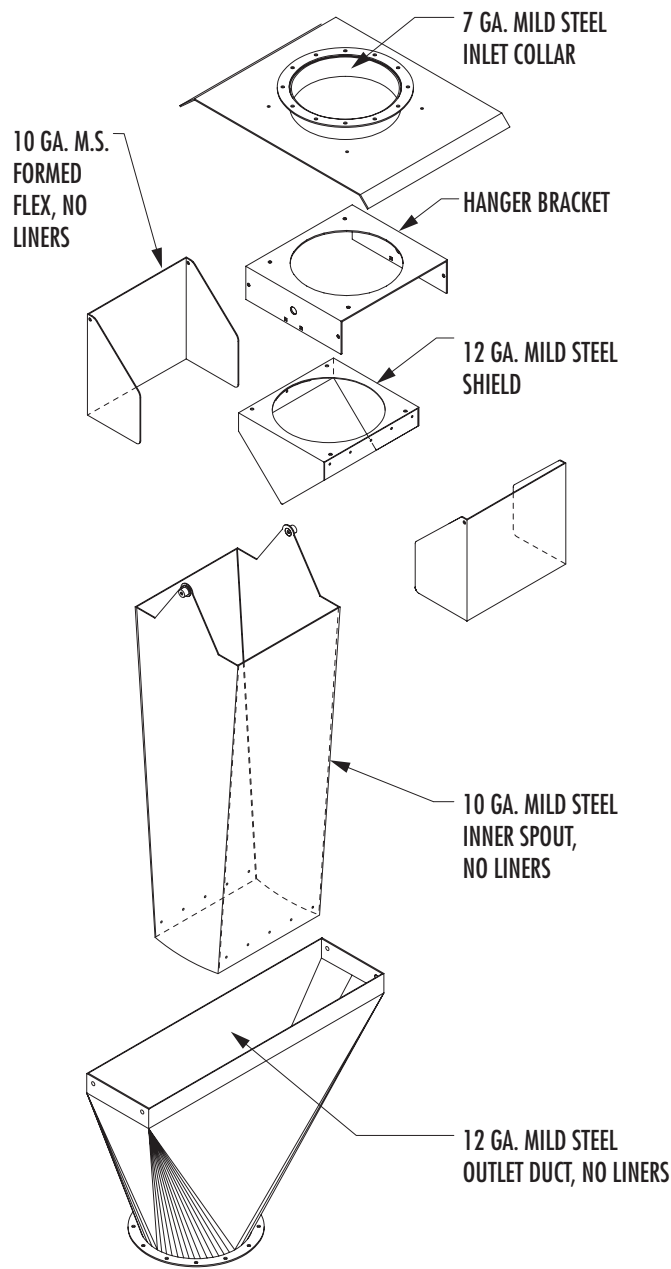

MEDIUM DUTY LINING

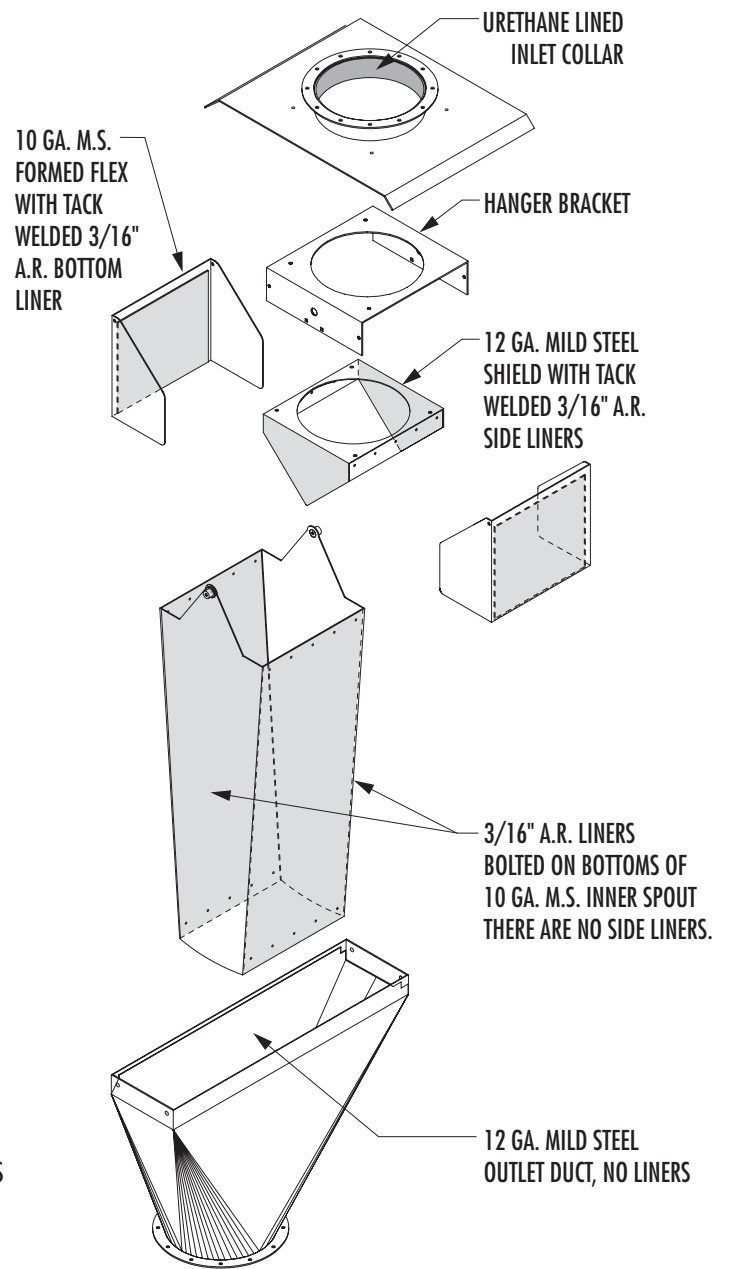

HEAVY DUTY LINING

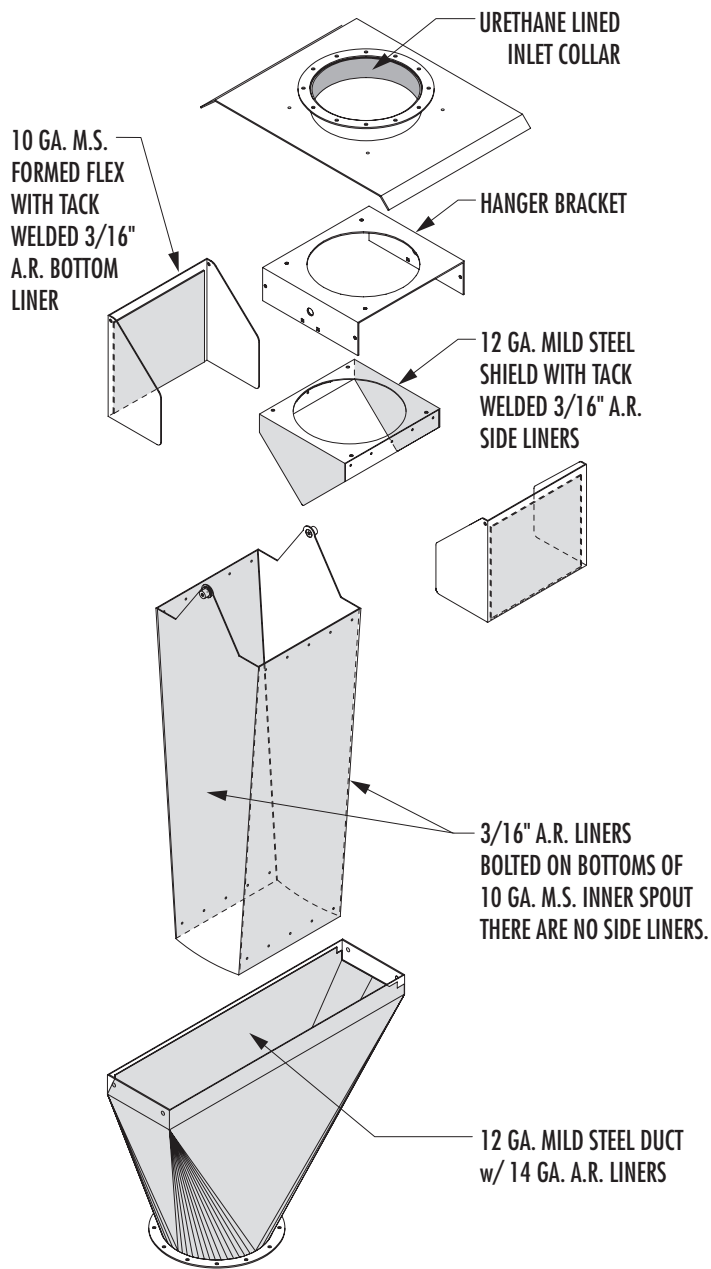

EXTRA HEAVY DUTY LINING

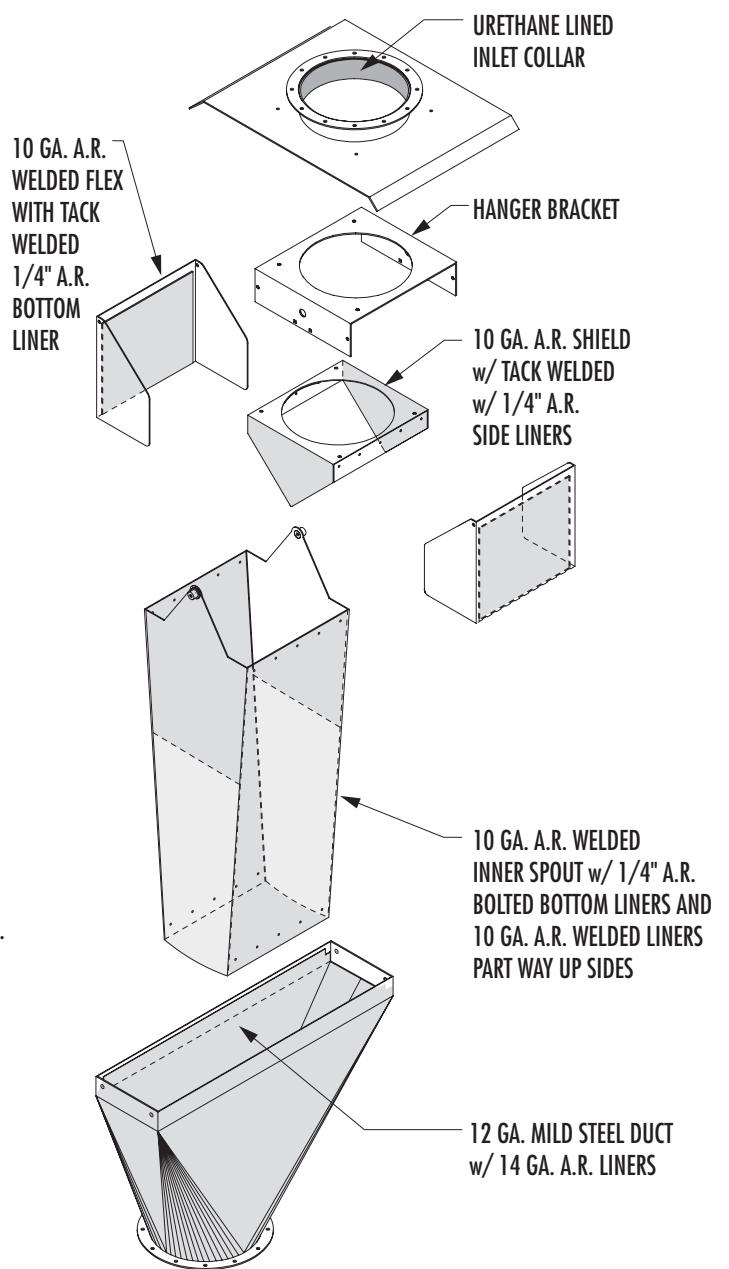

SEVERE DUTY LINING

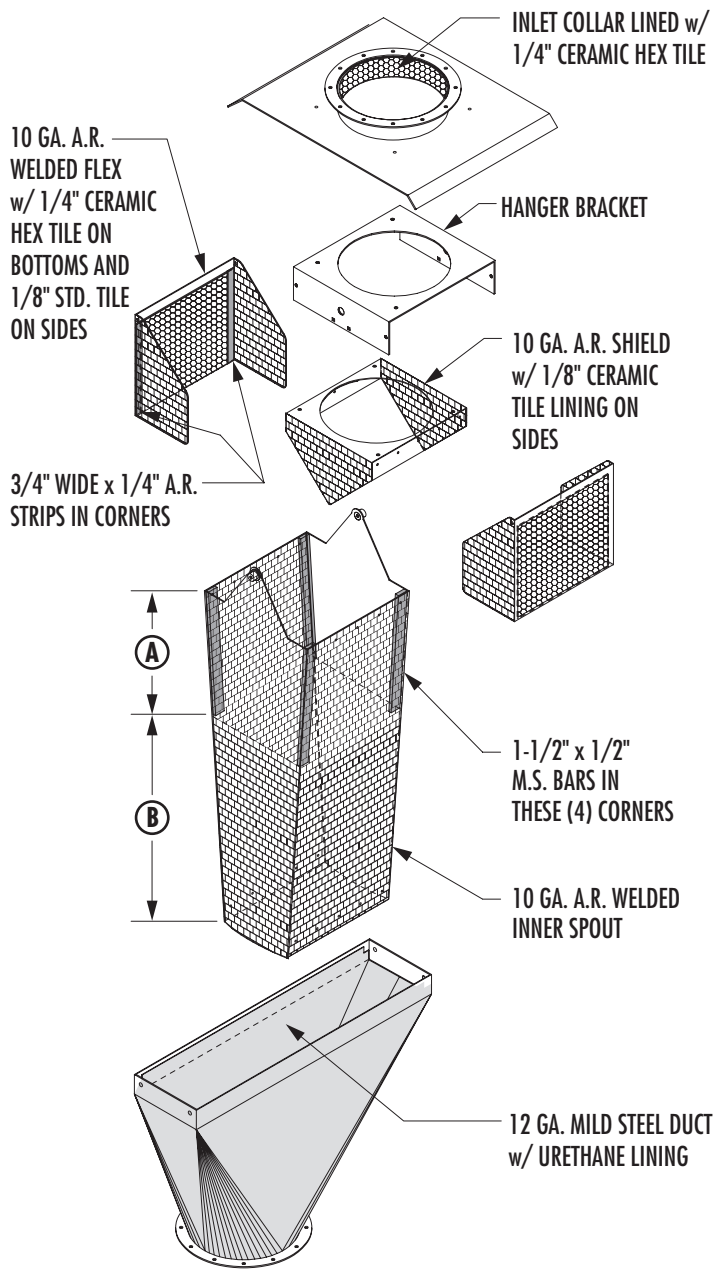

- (A) 1/4" CERAMIC TILE ON THE TWO  
OPPOSITE SIDES ONLY (BETWEEN BARS)
- (B) 1/4" CERAMIC TILE LINING  
ALL 4 SIDES

E1 TILE LINING

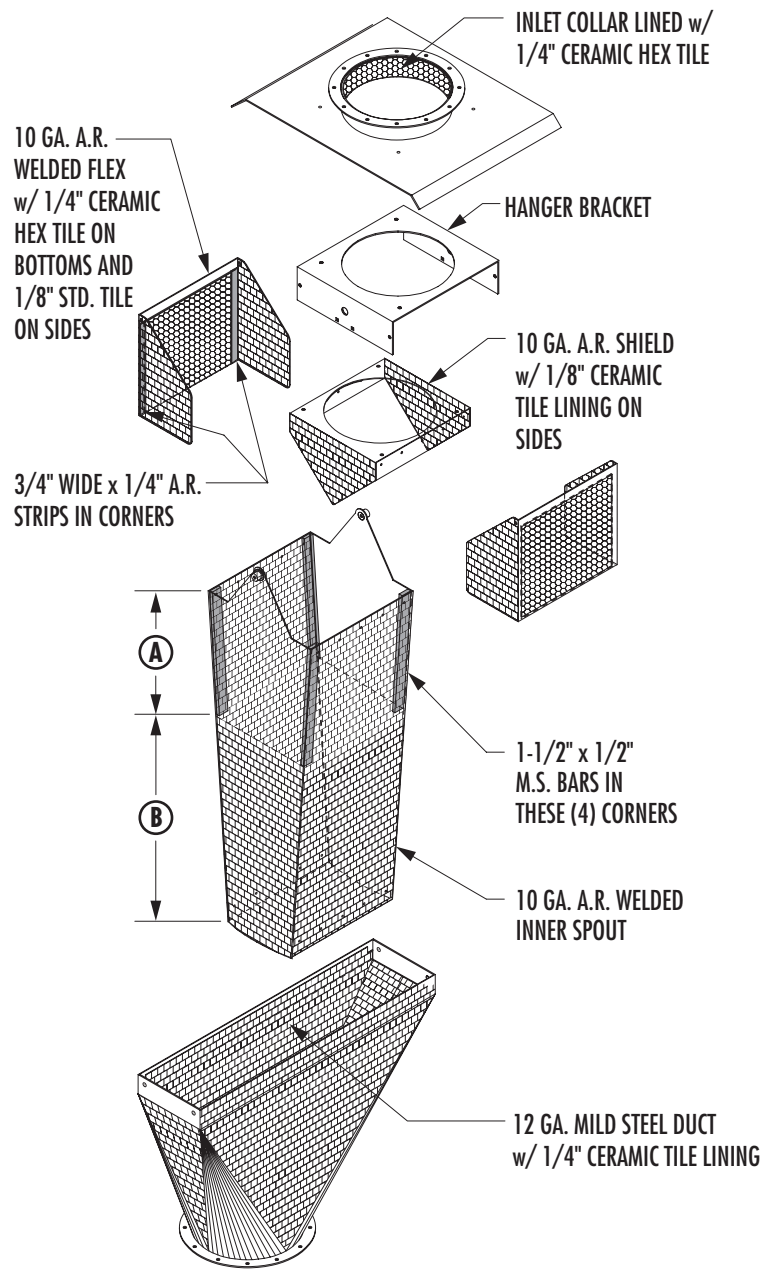

- (A) 1/4" CERAMIC TILE ON THE TWO  
OPPOSITE SIDES ONLY (BETWEEN BARS)
- (B) 1/4" CERAMIC TILE LINING  
ALL 4 SIDES



## SWINGSET DISTRIBUTOR LINERS

E2 lining is available on 12" and larger units with 6 ducts or more.

### E2 TILE LINING

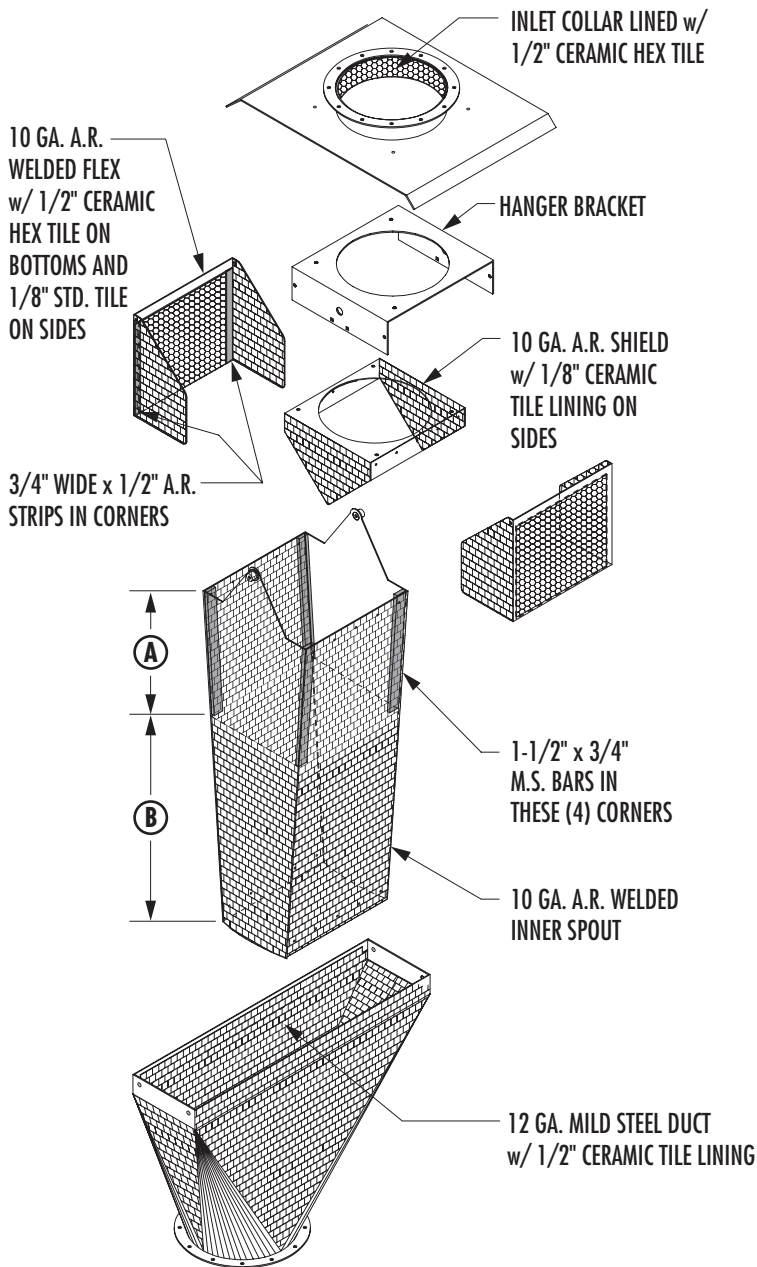

**(A)** 1/2" CERAMIC TILE ON THE TWO  
OPPOSITE SIDES ONLY (BETWEEN BARS)

**(B)** 1/2" CERAMIC TILE LINING  
ALL 4 SIDES

**NOTE:** 1/2" CERAMIC TILE WILL BE  
WELD IN STYLE ONLY WHEN POSSIBLE.

**NOTE:** FOR OTHER LINING OPTIONS CONTACT THE FACTORY.

# SWINGSET DISTRIBUTOR - DIMENSIONS

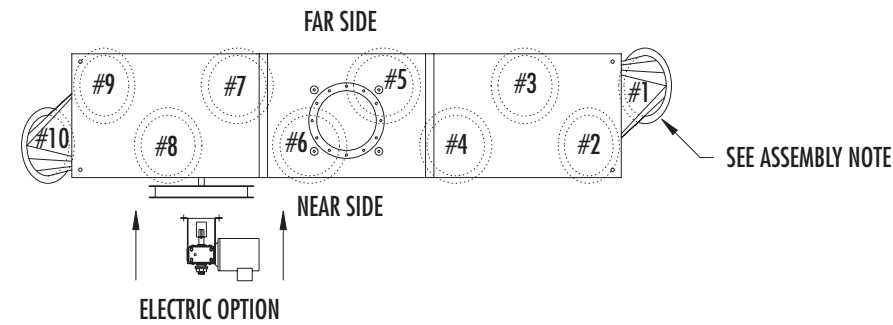

**NOTE:** Always locate #1 duct in the position shown. Locate remaining ducts in the staggered positions shown.

**CONSULT FACTORY FOR DIMENSIONS OF SMALL ELECTRIC DISTRIBUTORS**

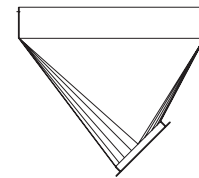
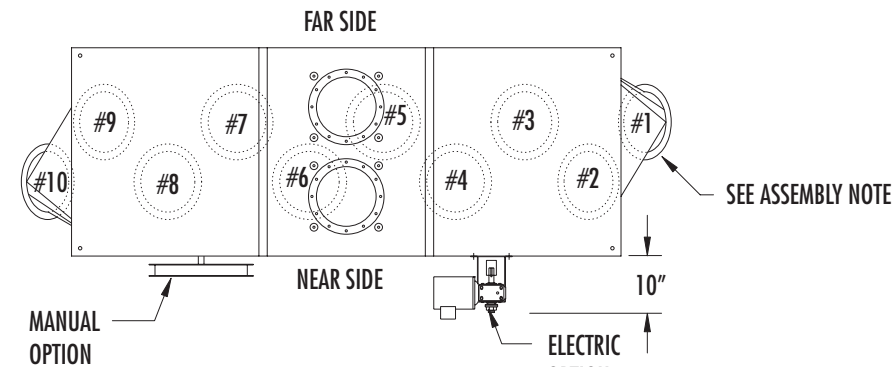

OPTIONAL STYLE 'B' DUCT  
\*CONSULT FACTORY FOR AVAILABILITY

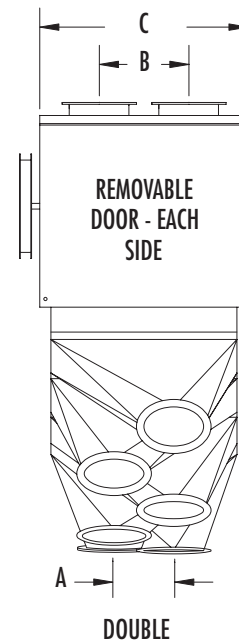
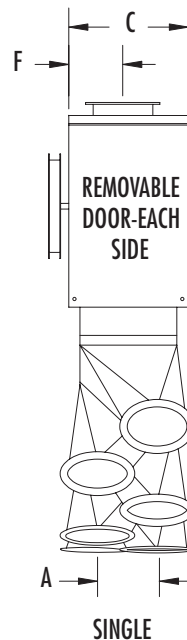
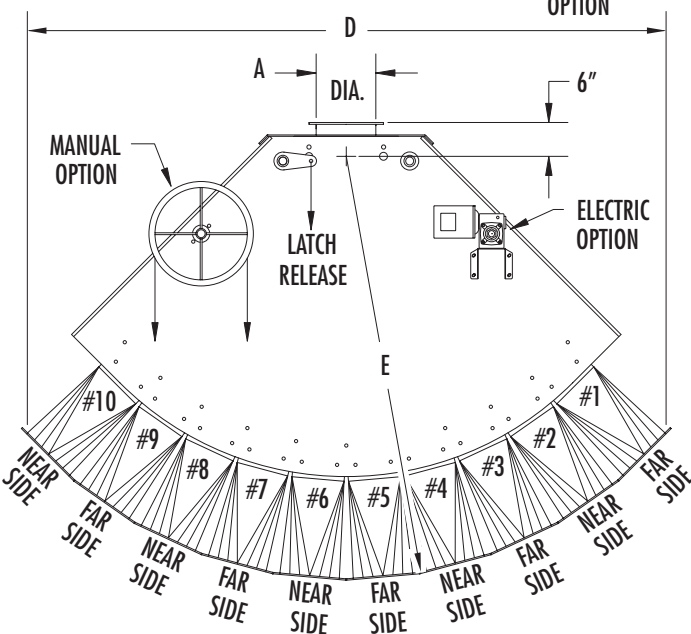

## SINGLE SPOUT

A	6"	8"	10"	12"	14"	16"	18"	20"	24"
C	15.25	17.25	20.25	22.25	25.25	27.25	29.25	32.25	37.25
F	7.125	8.125	9.625	10.625	12.125	13.125	14.125	15.625	18.125

## DOUBLE SPOUT

A	6"	8"	10"	12"	14"	16"	18"	20"	24"
B	11	13	16	18	21	23	25	28	33
C	25.25	29.25	35.25	39.25	45.25	49.25	53.25	59.25	69.25



# SINGLE & DOUBLE SPOUT ( D AND E - 45°/55° SPOUTS ) - DIMENSIONS

**NOTE:** Distributors in shaded areas will require special shipping arrangements.  
**CONSULT FACTORY.**

SPOUT SIZE	NO. DUCTS	SINGLE SPOUTS				DOUBLE SPOUTS			
		45°		55°		45°		55°	
		D	E	D	E	D	E	D	E
6"	4	33.71	30.63	33.71	30.63	36.06	33.42	41.24	39.29
	5	40.04	32.57	40.04	32.57	42.77	35.35	48.64	41.22
	6	46.92	31.36	46.03	34.13	50.44	33.96	56.02	42.64
	7	52.16	32.57	50.79	35.36	56.11	38.12	60.73	46.78
	8	56.74	35.81	55.57	38.61	60.69	42.28	65.51	50.94
	9	61.30	39.04	58.80	42.76	65.25	45.51	68.74	55.09
	10	65.86	42.27	62.03	46.91	69.81	48.74	71.97	59.24
	11	70.42	45.50	65.26	51.06	74.37	51.97	75.20	63.39
	12	74.98	48.73	68.49	55.21	78.93	55.20	78.43	67.54
	13	79.54	51.96	71.72	59.36	83.49	58.43	81.66	71.69
	14	84.10	55.19	74.95	63.51	88.05	61.66	84.89	75.84
	15	88.66	58.42	78.18	67.66	92.61	64.89	88.12	79.99
	16	93.22	61.65	81.41	71.81	97.17	68.12	91.35	84.14
	17	97.78	64.88	84.64	75.96	101.73	71.35	94.58	88.29
	18	102.34	68.11	87.87	80.11	106.29	74.58	97.81	92.44
	19	106.90	71.34	91.10	84.26	110.85	77.81	101.04	96.59
	20	111.46	74.57	94.33	88.41	115.41	81.04	104.27	100.74
8"	4	45.44	32.02	45.44	32.02	49.57	35.62	57.16	42.24
	5	53.07	34.95	52.14	37.86	57.69	38.55	63.86	48.08
	6	60.14	37.22	58.81	43.68	65.23	40.86	70.54	53.89
	7	66.55	41.74	65.47	49.84	71.64	45.34	77.19	59.71
	8	72.94	46.26	72.12	55.28	78.03	49.86	83.85	65.51
	9	79.33	50.77	78.77	61.07	84.42	54.37	90.50	71.30
	10	85.72	55.28	85.42	66.86	90.81	58.88	97.15	77.09
	11	92.11	59.79	92.07	72.65	97.20	63.39	103.80	82.88
	12	98.50	64.30	98.72	78.44	103.59	67.90	110.45	88.67
	13	104.89	68.81	105.37	84.23	109.98	72.41	117.10	94.46
	14	111.28	73.32	112.02	90.02	116.37	76.92	123.75	100.25
	15	117.67	77.83	118.67	95.81	122.76	81.43	130.40	106.04
	16	124.06	82.34	125.32	101.60	129.15	85.94	137.05	111.83
	17	130.45	86.85	131.97	107.39	135.54	90.45	143.70	117.62
	18	136.84	91.36	138.62	113.18	141.93	94.96	150.35	123.41
	19	143.23	95.87	145.27	118.97	148.32	99.47	157.00	129.20
	20	149.62	100.38	151.92	124.76	154.71	103.98	163.65	134.99
10"	4	53.02	37.19	53.02	37.19	58.09	41.62	67.92	50.19
	5	61.79	40.54	60.67	43.87	67.47	44.96	75.57	56.86
	6	69.92	43.13	68.28	51.51	76.17	47.55	83.19	63.49
	7	77.23	48.29	75.88	57.13	83.48	52.72	90.79	70.13
	8	84.52	53.45	83.48	63.75	90.77	57.87	98.38	76.74
	9	91.81	58.61	91.07	70.37	98.06	63.03	105.97	83.36
	10	99.10	63.77	98.66	76.99	105.35	68.19	113.56	89.98
	11	106.39	68.93	106.25	83.61	112.64	73.35	121.15	96.60
	12	113.68	74.09	113.84	90.23	119.93	78.51	128.74	103.22
	13	120.97	79.25	121.43	96.85	127.22	83.67	136.33	109.84
	14	128.26	84.41	129.02	103.47	134.51	88.83	143.92	116.46
	15	135.55	89.57	136.61	110.09	141.80	93.99	151.51	123.08
	16	142.84	94.73	144.20	116.71	149.09	99.15	159.10	129.70

**SINGLE & DOUBLE SPOUT ( D AND E - 45°/55° SPOUTS ) - DIMENSIONS** *CONTINUED*

SPOUT SIZE	NO. DUCTS	SINGLE SPOUTS				DOUBLE SPOUTS			
		45°		55°		45°		55°	
		D	E	D	E	D	E	D	E
10"	17	150.13	99.89	151.79	123.33	156.38	104.31	166.69	136.32
	18	157.42	105.05	159.38	129.95	163.67	109.47	174.28	142.94
	19	164.71	110.21	166.97	136.57	170.96	114.63	181.87	149.56
	20	172.00	115.37	174.56	143.19	178.25	119.79	189.46	156.18
12"	4	63.88	40.64	62.66	43.77	72.97	47.71	79.55	58.49
	5	73.27	47.94	72.21	52.09	82.36	55.01	89.09	66.82
	6	83.11	51.17	81.71	60.38	93.11	58.24	98.59	75.11
	7	92.23	57.62	91.21	68.66	102.23	64.69	108.09	83.38
	8	101.34	64.06	100.68	76.92	111.34	71.13	117.56	91.64
	9	110.46	70.51	110.17	85.20	120.46	77.58	127.05	99.92
	10	119.58	76.96	119.66	93.48	129.58	84.03	136.54	108.20
	11	128.70	83.41	129.15	101.76	138.70	90.48	146.03	116.48
	12	137.82	89.86	138.64	110.04	147.82	96.93	155.52	124.76
	13	146.94	96.31	148.13	118.32	156.94	103.38	165.01	133.04
	14	156.06	102.76	157.62	126.60	166.06	109.83	174.50	141.32
	15	165.18	109.21	167.11	134.88	175.18	116.28	183.99	149.60
	16	174.30	115.66	176.60	143.16	184.30	122.73	193.48	157.88
	17	183.42	122.11	186.09	151.44	193.42	129.18	202.97	166.16
	18	192.54	128.56	195.58	159.72	202.54	135.63	212.46	174.44
	19	201.66	135.01	205.07	168.00	211.66	142.08	221.95	182.72
	20	210.78	141.46	214.56	176.28	220.78	148.53	231.44	191.00
14"	4	74.48	45.36	70.07	48.81	84.39	55.41	93.38	69.13
	5	81.81	53.39	80.57	57.96	94.72	63.43	103.88	78.28
	6	92.69	56.95	91.02	67.07	106.89	66.98	114.33	87.39
	7	102.71	66.04	101.45	76.16	116.92	74.08	124.76	96.48
	8	112.72	71.11	111.87	85.25	126.93	81.16	135.18	105.56
	9	122.73	78.18	122.29	94.33	136.94	88.23	145.60	114.64
	10	132.74	85.25	132.71	103.41	146.95	95.30	156.02	123.72
	11	142.75	92.32	143.13	112.49	156.96	102.37	166.44	132.80
	12	152.76	99.39	153.55	121.57	166.97	109.44	176.86	141.88
	13	162.77	106.46	163.97	130.65	176.98	116.51	187.28	150.96
	14	172.78	113.53	174.39	139.73	186.99	123.58	197.70	160.04
	15	182.79	120.60	184.81	148.81	197.00	130.65	208.12	169.12
	16	192.80	127.67	195.23	157.89	207.01	137.72	218.54	178.20

**NOTE:** Distributors in shaded areas will require special shipping arrangements.  
**CONSULT FACTORY.**

**NOTE: CONSULT FACTORY FOR 14" UNITS OVER 16 DUCTS**

**SINGLE & DOUBLE SPOUT ( D AND E - 45°/55° SPOUTS ) - DIMENSIONS** *CONTINUED*

**NOTE:** Distributors in shaded areas will require special shipping arrangements.  
**CONSULT FACTORY.**

SPOUT SIZE	NO. DUCTS	SINGLE SPOUTS				DOUBLE SPOUTS			
		45°		55°		45°		55°	
		D	E	D	E	D	E	D	E
16"	4	80.64	51.29	79.23	55.37	95.84	63.11	104.53	77.42
	5	92.83	60.78	91.63	66.17	108.03	72.59	116.93	88.23
	6	105.46	64.98	103.97	76.93	122.17	76.79	129.27	98.98
	7	117.29	73.35	116.29	87.67	134.01	85.17	141.58	109.72
	8	129.12	81.71	128.59	98.39	145.83	93.52	153.89	120.44
	9	140.94	90.07	140.90	109.11	157.65	101.88	166.20	131.16
	10	152.76	98.43	153.21	119.83	169.47	110.24	178.51	141.88
	11	164.58	106.79	165.52	130.55	181.29	118.60	190.82	152.60
	12	176.40	115.15	177.83	141.27	193.11	126.96	203.13	163.32
	13	188.22	123.51	190.14	151.99	204.93	135.32	215.44	174.04
	14	200.04	131.87	202.45	162.71	216.75	143.68	227.75	184.76

**NOTE: CONSULT FACTORY FOR 16" UNITS OVER 14 DUCTS.**

18"	4	83.93	57.25	88.41	61.94	106.99	70.60	115.70	85.73
	5	103.88	68.18	102.71	74.41	121.05	81.53	130.04	98.18
	6	118.25	73.02	116.94	86.81	137.13	86.37	144.23	110.59
	7	131.91	82.68	131.14	99.19	150.78	96.02	158.42	122.97
	8	145.53	92.31	145.32	111.55	164.41	105.66	172.61	135.33
	9	159.16	101.95	159.52	123.91	178.04	115.30	186.80	147.69
	10	172.79	111.59	173.72	136.27	191.67	124.94	200.99	160.05
	11	186.42	121.23	187.92	148.63	205.30	134.58	215.18	172.41
	12	200.05	130.87	202.12	160.99	218.93	144.22	229.37	184.77

**NOTE: CONSULT FACTORY FOR 18" UNITS OVER 12 DUCTS**

20"	4	97.41	61.95	95.81	66.96	117.12	77.28	122.64	90.35
	5	112.41	73.62	111.06	80.25	132.11	88.94	137.87	103.63
	6	127.81	78.78	126.23	93.48	149.48	94.11	153.06	116.86
	7	142.36	89.07	141.37	106.68	164.04	104.39	168.19	130.06
	8	156.89	99.35	156.49	119.87	178.57	114.68	183.32	143.25
	9	171.41	109.61	171.60	133.04	193.09	124.94	198.43	156.42
	10	185.93	119.87	186.71	146.21	207.61	135.20	213.54	169.59

**NOTE: CONSULT FACTORY FOR 20" UNITS OVER 10 DUCTS**

24"	4	106.04	66.29	104.06	71.29	131.69	86.24	135.85	99.01
	5	121.03	77.95	119.29	84.58	146.69	97.91	151.08	122.29
	6	136.75	83.11	134.47	97.81	164.98	103.36	166.26	125.52
	7	151.31	93.41	149.62	111.01	179.54	113.36	181.41	138.72
	8	168.85	103.68	164.74	124.19	194.07	123.63	196.53	151.91

**NOTE: CONSULT FACTORY FOR 24" UNITS OVER 8 DUCTS**

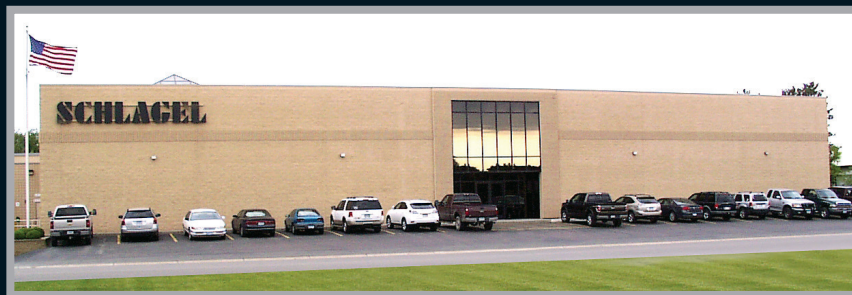

# SCHLAGEL

491 North Emerson Street • Cambridge MN 55008-1316 U.S.A.  
Toll Free (800) 328-8002 FAX (763) 689-5310  
Local / International (763) 689-5991 EMAIL [sales@schlagel.com](mailto:sales@schlagel.com)

**[www.schlagel.com](http://www.schlagel.com)**

©2015 Schlagel Inc. 02/15 Rev. C Printed in U.S.A.